



NBCG Multi Aperture Metal Cable Glands–Metric Thread



Metal Cable Gland with Multi Aperture Elastomeric Inserts for Liquid Tight Cable Sealing.

Characteristics :

- Body: Brass with Nickel Plating Treatment
- Adjustable Insert: Polyamide-6
- Seal Material: TPE/TPE-V/EPDM/NBR
- Metric Threads conforming to IEC 60423
- Protection Degree: IP-68
- Free of Halogens, Cadmium, Sulphur & Phosphorous

Applications



Rail Vehicles (Internal Applications)



Earth Moving Equipment



Industrial Machinery



Solar & Wind Installations

- Insert Material-(X)
- NBR - NB
- EPDM - EP
- TPE - TE
- TPE-V - TV

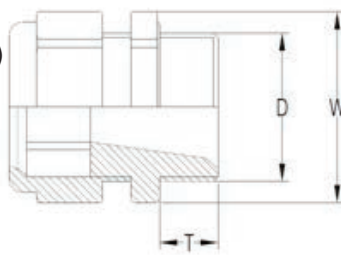

Sealing Insert Hole Configuration can be customized based on requirement.

DIMENSIONAL DETAILS

Part No.	Thread Size	Insert Configuration	Thread Length T (mm)	Dimension D (mm)	Wrench Size (mm)	PPQ (nos.)
NBCG-M18 – X. 2x3	M18X1.5	2 x 3mm	7	18	20	100
NBCG-M20 – X. 2x5	M20X1.5	2 x 5mm	8	20	22	50
NBCG-M20 – X. 3x4	M20X1.5	3 x 4mm	8	20	22	50
NBCG-M25 – X. 2x6	M20X1.5	2 x 6mm	9	25	30	25
NBCG-M25 – X. 4x6	M25X1.5	4 x 6mm	9	25	30	25
NBCG-M32 – X. 10x6	M32X1.5	10 x 6mm	10	32	40	20
NBCG-M32 – X. 3x10	M32X1.5	3 x 10mm	10	32	40	20
NBCG-M32 – X. 6x6	M32X1.5	6 x 6mm	10	32	40	20
NBCG-M32 – X. 4x4.2	M32X1.5	4 x 4.2mm	10	32	40	20
NBCG-M32 – X. 18x2.6	M32X1.5	18 x 2.6mm	10	32	40	20
NBCG-M40 – X. 2x15	M40X1.5	2 x 15mm	13	40	52	10
NBCG-M40 – X. 9x7	M40X1.5	9 x 7mm	13	40	52	10
NBCG-M40 – X. 10x5	M40X1.5	10 x 5mm	13	40	52	10
NBCG-M40 – X. 8x7.5	M40X1.5	8 x 7.5mm	13	40	52	10
NBCG-M40 – X. 45x2.6	M40X1.5	45 x 2.6mm	13	40	52	10
NBCG-M40 – X. 22x3.5/5x5	M40X1.5	22 x 3.5mm/ 5x5 mm	13	40	52	10
NBCG-M40 – X. 14x3.5/2x7.5	M40X1.5	14 x 3.5mm/ 2x7.5 mm	13	40	52	10
NBCG-M50 – X. 4x13	M50X1.5	4 x 3mm	12	50	60	10
NBCG-M63 – X. 5x12	M63X1.5	5 x 12mm	12	63	68	5